



STUDENT HANDBOOK 2011-12

Administrators:

Dean Hess, Principal

Larry Mancl, Associate Principal

Jason McFarlane, Associate Principal

(715) 261-0100

1400 Stewart Avenue

Wausau, Wisconsin 54401

This agenda belongs to

NAME _____

STUDENT NO. _____

HOMEROOM NO. _____

Table of Contents

Principal’s Message.....	1
Staff	2-3
School Calendar.....	4
Student Safety Concerns.....	5
Activities.....	6
Harassment	7-8
Attendance.....	9-10
Other Information	
Behavior at Assemblies/Performances	10
Cell Phone & Two-Way Radio Use	10
Activity Fee	11
Bicycles, Skateboards, Rollerblades.....	11
Fire & Tornado Drills	11
Valuables	11
Visitors.....	11
Emergency Closings	11
Field Trips.....	11
Lost & Found.....	12
Accidents	12
Recording Devices.....	12
Auditions	12
Class Schedules	13
Building Hours	13
Hall Passes.....	13
Bulletins & Announcements.....	13
Security Cameras.....	13
Telephones.....	13
Dances & Student Council Sponsored Activities	14
Textbooks	14
Communicable Disease Policy	14
Grading & Honors	15
Physical Education Requirements	16
Computer Use/Misuse	16
Student Conduct	
Classroom Behavior	17
Public Displays of Affection	17
Detentions.....	17
Laser Pointers	18
Tobacco Products	18
Locker Policy.....	18
Juvenile Citations	18
Expectations Outside of the Classroom.....	18
Unsafe Actions	18
Selling & Solicitation	18
Fireworks.....	18
Suspension/Expulsion.....	19
Dress & Appearance.....	20

Table of Contents (continued)

Student Services	
Insurance.....	21
Health Services.....	21
Counseling.....	21
IMC.....	21
School Resource Officer.....	21
Student Council.....	22
Student Support System.....	22
John Muir Voice Mailboxes & WIKI.....	22
Transportation.....	23
Lunch Period Procedures.....	24
8th Grade Promotion Policy.....	25
Academic Honesty.....	26
Homework Policy.....	26
Final Draft Requirements.....	27
Quick 50.....	28
WSD Mission Statement.....	29-30
Partners in Education.....	31
WSD Continuous Nondiscrimination Notice.....	32
John Muir Building Maps.....	33-34
Notes.....	35
Scavenger Hunt.....	36-37

PRINCIPAL'S MESSAGE

Welcome to John Muir Middle School! The time of early adolescence is one of intense learning and also a time of significant change. It is a time when students must deal with changing bodies and added responsibilities, as well as exciting opportunities. The staff at John Muir recognizes these unique needs and is well trained in assisting middle school students in realizing their potential.

Our staff at John Muir is dedicated to offering our students the best educational environment possible. We strive to work together as a team to build relationships with our students and their parents/guardians. We also pride ourselves on constantly evaluating our programming and adjusting as necessary to make learning exciting and fun. This Student Handbook will answer many of your questions. The policies and expectations described are reasonable and necessary for maintaining an atmosphere that allows each student to develop to the best of her/his ability. It is expected that students will use this assignment handbook to become better students.

Best wishes for a great year!

Dean R. Hess
Principal

THE MAN BEHIND THE NAME

John Muir was born April 21, 1838, in Dunbar, Scotland. At the age of 11, he left on a ship bound for America with his father and a 13 year old sister. The rest of the family would join them later. The Muirs settled in the wilderness of central Wisconsin. John took an interest in nature, but he put that aside at age 22 to enter the University of Wisconsin in 1860.

After graduation, his desire to explore the natural world led him to Europe, Asia, Africa, the Arctic, and many areas of the United States.

At Muir's urging, Yosemite National Park was created in 1890, specifically to preserve its wilderness character. Muir made his most valuable contributions to scientific knowledge in the field of glaciology. He personally discovered several glaciers, including one in Alaska that bears his name.

Muir tended to become physically ill when he stayed too long confined by civilization. He remained a man of the wilderness until his death in 1914. His words in a letter to his sister in 1873 summarize his life: "The mountains are calling and I must go."

He helped establish conservation as an accepted outlook on our environment and its natural resources. It is an outlook that still requires championing today!

JOHN MUIR TEAMS

Team 6-1

S. Kostroski, Team Leader

A. Bethel, Science
 K. Christensen, CD
 C. Eick, LD
 M. Gilbertson, Literacy
 S. Kostroski, Math
 T. Kramar, ELL
 S. MacEachern, Science
 S. Markofski, Math
 S. Murphy, Literacy
 M. Quiett, EBD
 H. Wiesman, Social Studies
 D. Zuelke, Social Studies

S. Falk, 6th Grade Counselor

Art	Technology	Health
K. Bloomer, R. Priebe	B. Bauer, J. Winter	C. Swope, P. Zemke

Team 6-2

P. Colwell, Team Leader

P. Colwell, Science
 K. Gilbertson, Literacy
 T. Lang, READ 180
 T. Larson, Social Studies
 S. MacEachern, Science
 S. Markofski, Math
 M. Quiett, EBD
 P. Reed, Literacy
 S. Wurzer, LD
 D. Zuelke, Social Studies
 TBD, Math

Team 7-1

B. Lind, Team Leader

T. Carungi, Math
 K. Christensen, CD
 K. Colwell, Science
 K. Johnson, Literacy
 T. Lang, READ 180
 B. Lind, Literacy
 S. MacEachern, Science
 B. Mesenberg, Social Studies
 M. Quiett, EBD
 J. Salzman, Math
 A. Sims, LD
 D. Zuelke, Social Studies

C. Valitchka, 7th Grade Counselor

Art	Technology	FC/E	Word Cultures
K. Bloomer	B. Bauer, K. Hopperdietzel	J. Genrich, L. Bastable	J. Mistlebauer, H. Janssen

Team 7-2

L. Larson, Team Leader

A. Christianson, Social Studies
 T. Forbes, ELL
 C. Jeffers, Literacy
 T. Lang, READ 180
 L. Larson, Literacy
 S. MacEachern, Science
 C. Peterson, Math
 R. Phelps, Math
 M. Quiett, EBD
 M. Reif, LD
 J. Salzman, Math
 P. Teuke, Science
 D. Zuelke, Social Studies

Team 8-1

P. deJong, Team Leader

T. Betry, Math
 S. Clure, Literacy
 P. deJong, Social Studies
 M. Joswick, LD
 T. Lang, READ 180
 K. LaPorte, Literacy
 B. Mesenberg, Social Studies
 C. Peterson, Math
 M. Quiett, EBD
 R. Riehle, Science
 Y. Senanayake, Science

H. Janssen, French; K. LaPorte, German; L. Schimmels, Spanish

H. Schmidt, 8th Grade Counselor

Art	Technology	FC/E
R. Priebe	K. Hopperdietzel, J. Winter	J. Genrich, L. Bastable

Team 8-2

R. Erdman, Team Leader

J. Buelow, Social Studies
 K. Christensen, CD
 P. Ellenbecker, LD
 R. Erdman, Science
 T. Lang, READ 180
 K. LaPorte, Literacy
 J. Nieuwenhuis, Literacy
 M. Quiett, EBD
 Y. Senanayake, ELL & Science
 J. Salzman, Math
 J. Smogoleski, Math

MUSIC

J. Hettinga
R. Jaeger
C. Engel
J. Murray
R. Swoboda
TBD
K. Zuidema

PHY ED

S. Betry
L. LaRue
S. Saari
M. Timken
M. Yang

Enrichment Coordinator
Learning Media Center
Nurse
Psychologist
School Resource Officer
Speech/Language
Teacher of DHH
Teacher of Visually Impaired

B. Lind
L. Morrissey
J. Pavlovich
J. Schulz
M. Wogernese
B. Augustine
K. Koch-Engstrum
K. Schultz

Secretaries

Principal's Secretary—M. Heyer
Associate Principal's Secretary—J. Ladwig
Counseling Office Secretary—S. Gallant
Administrative Technical Assistant—M. Wood
Attendance Secretary—J. Gaulke

Custodians

J. Heiting—Head Custodian C. Seymour
M. Hanke J. Weinke
S. Lee T. Westberg
D. Neumann

Food Services

M. Hills - Foods Manager K. Juedes
L. Baine K. Saager
C. Dohm C. Santama
H. Gilles L. Schlicht
R. Ison T. Trantow

Paraprofessionals

Para - C. Bacon
Para - D. Kuharske
Para - R. Pittsley
BLTA - L. Utecht
DHH Intptr - T. Covelli
EEN - B. Felver
EEN - L. Kramer
EEN - L. Miller
EEN - L. Rueth
EEN - M. Socha
EEN - C. Sperry
EEN - M. Steines
ELL - M. Chang
ELL - K. Yang
ELL - M. Yang
Health Aide - C. Baars
Pool Supervisor - B. Phillips
VI Aide - L. Imhoff

2011-2012 SCHOOL CALENDAR

September 1	-	First Day of School
September 5	-	Labor Day - No Classes
September 21	-	Picture Day
September 22	-	Bingo Night 3-4 p.m. Room 140
Wk. of Sept. 26	-	Boys' Basketball Signup for 7th & 8th grades
Sept. 21-30	-	Team 6-2 School Forest
October 3	-	District Staff Development—No Classes
October 10, 13, 18	-	Parent/Teacher Conferences 3:30 - 7:30 p.m.
Wk. of October 17	-	Wrestling Signup for 6th, 7th & 8th grades
October 21	-	7th Grade Dance 3-5:30 p.m.
October 24	-	City-Wide Orchestra Festival 7:30 p.m. @ Wausau East
October 27 & 28	-	Fall Break
Wk. Of Nov. 7	-	School Play Auditions 3-5 p.m.
November 12	-	Singing in Wisconsin @ Wausau East
Wk. of November 14	-	Intramural Ski Signup for 6th, 7th & 8th grades
November 17	-	7th Grade Band/Orchestra/Choir Concert 7 p.m. Auditorium
November 23	-	District Staff Development - No Classes
November 24 & 25	-	Thanksgiving Break
Wk. of December 5	-	Basketball Signup for 7th & 8th Grade Girls
December 6	-	8th Grade Band/Orchestra/Choir Concert 7 p.m. Auditorium
Dec. 26 - Dec. 30	-	Winter Break (classes resume January 2)
January 13	-	8th Grade Winter Frolic Dance 7-10 p.m.
January 20	-	District Staff Development - No Classes
January 26 & 27	-	School Play 7 p.m. Auditorium
February 6	-	John Muir Spelling Bee 3-5 p.m. Large Group Room
February 9	-	6th Grade Band/Orchestra/Choir Concert 7 p.m. Auditorium
February 16, 20	-	Parent/Teacher Conferences 3:30-6:30 p.m.
Wk. of February 20	-	Track Signup for 6th, 7th & 8th grades
February 20	-	District Staff Development - No Classes
February 25	-	Solo/Ensemble Festival @ D.C. Everest
March 2	-	6th Grade Fun Night 3-5 p.m.
March 23	-	No Afternoon Classes
March 26-30	-	Spring Break (classes resume April 2)
April 6	-	No Classes
April 16-17	-	Talent Show 7 p.m. Auditorium
April 20	-	District Staff Development - No Classes
April 24	-	Spring Photos
April 26	-	Bingo Night 3-4 p.m. Room 140
May 1	-	5th Grade Parent Breakfast 7:45 a.m.
May 3	-	5th Grade Parent Informational Meeting 7 p.m. Large Group Room
May 7-11& 14-16	-	Team 6-1 School Forest
May 8	-	7th Grade Choir Concert 7 p.m. Auditorium
May 15	-	John Muir Orchestra Concert 7 p.m. Auditorium
May 18	-	8th Grade Farewell Dance 7-10 p.m.
May 22	-	8th Grade Awards Ceremony 7 p.m. Auditorium
May 21 or 24 (TBA)	-	John Muir Band Concert 7 p.m. Gymnasium
May 25	-	No Afternoon Classes
May 28	-	Memorial Day - No Classes
May 29	-	8th Grade Choir Concert 7 p.m. Auditorium
June 1	-	Last Day (make-up dates for inclement weather June 4 & 5)

STUDENT SAFETY CONCERNS

Every student has the right to attend the Wausau School District without fear of being threatened or harmed in any way, either verbally or physically. In order to make this goal a reality, the school administration at the Wausau School District will enforce the following consequences for rule violations:

A recommendation for expulsion from the Wausau School District will be made to the Wausau Board of Education for the following behaviors at school or at school-sponsored activities:

- Possession of a gun
- Possession of a dangerous weapon with intent to threaten or cause bodily harm to others or to cause property damage
- Intentional use of unprovoked force against a Wausau School District employee

Students may be recommended to the Wausau Board of Education for expulsion from the Wausau School District for the following behaviors at school or at school-sponsored activities:

- Starting a fire, or attempting to start a fire, on school premises
- Disrupting the school environment through the use of violence or threats of violence
- Acting in a way that threatens the life or health of another person where such conduct is considered criminal by federal, state, or local laws
- Sexually assaulting another person
- Setting off the school's fire alarm system or falsely reporting a fire when no fire exists
- Making a bomb threat or placing a false alarm call
- Possession of, under the influence of, selling, dispensing or delivering drugs or chemicals which Wisconsin Statutes define as illegal

Suspension from school for up to five days may result for a student committing any of the following behaviors at school or at school-sponsored activities:

- Making threats against any Wausau School District employee
- Verbal, physical or sexual harassment of another person
- Failure to identify yourself to a school staff member
- Vandalism to school property or equipment
- Possessing or being under the influence of alcohol
- Forcing someone to act against their will through the use of intimidation and/or threats
- Sexually explicit/obscene conduct
- Use of profane or obscene language/gestures toward any member of the Wausau School District
- Theft of school property or equipment
- Refusing to leave the school's premises when directed by a school official
- Obtaining, or attempting to obtain, money or property from someone who's unwilling to give it to you
- Use of physical force against another student

CODE OF STUDENT CONDUCT

The Wausau School District recognizes and accepts its responsibility to create, foster, and maintain an orderly and safe class environment, conducive to teaching and to the learning process. Equally important, the District owes its students the opportunity to attend school as free as reasonably possible from unnecessary and unwarranted distraction and disruption, particularly by those relatively few students who, for whatever reason, are unwilling, unready, or unable to avail themselves of the opportunity for an education.

ACTIVITIES

Athletic programs at the middle school level should be exciting, wonderful experiences for students participating. A variety of activities are offered. These programs are held under a safe and professionally supervised environment. We hope most boys and girls will be involved in at least one activity. Please be aware of all the forms, user fees, physicals, etc. that are needed before participation. We believe we have unique opportunities for students to learn from, participate in and have fun doing!

A wide variety of intramural activities will be also be offered. Activities offered are based on the interest of students and staff. Some of the many activities that will be offered are: 6th grade girls' volleyball, 6th grade boys' and girls' basketball, and skiing. A user fee will also be assessed for intramural activities.

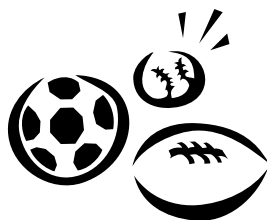

WIAA Interscholastic Sports

Fall

8th grade boys' football
7th & 8th grade girls' volleyball
6th, 7th, 8th grade girls' swimming
6th, 7th, 8th gr. co-ed cross country
7th & 8th grade co-ed soccer

Winter

7th grade boys' basketball
8th grade boys' basketball
7th grade girls' basketball
8th grade girls' basketball
6th, 7th, 8th grade boys' wrestling



Spring

6th, 7th & 8th grade boys' and girls' track



HARASSMENT

Harassment can take many forms. It is unwanted behavior that interferes with your life. It limits and denies the rights of students to study, work and play in the school setting. Harassment makes people feel bad. Everyone has a right not to be harassed, and our staff feels strongly that all students should feel safe at school. If you are being harassed, tell the harasser to STOP and contact a staff member.

SEXUAL HARASSMENT

Sexual harassment is *UNWANTED* behavior of a sexual nature. There are school board policies, as well as state and federal laws, which prohibit sexual harassment. Some examples include inappropriate gestures or touch, sexual remarks, name-calling or spreading rumors, making sexual comments about one's body, or drawing or displaying offensive pictures.

VERBAL HARASSMENT

Verbal harassment is *UNWANTED* verbal comments which make a person feel bad or unsafe. Examples include teasing to cause embarrassment, threatening to cause harm to the person, or teasing about a person's clothes or appearance.

RACIAL HARASSMENT

Racial harassment is *UNWANTED* comments regarding a person's ethnic makeup. Examples include ethnic name-calling or making negative comments about a particular ethnic group.

PHYSICAL HARASSMENT

Physical harassment is *UNWANTED* behavior of a physical nature. Examples include pushing, striking another student, or causing harm. Physical harassment, in some cases, is against the law and is defined as battery, assault or disorderly conduct.

INTIMIDATION

Intimidation is *UNWANTED* threats to cause harm. Telling someone to watch his/her back or stating that someone else is going to beat him/her up are examples of intimidation. Another example is getting in someone's private space.

CYBER HARASSMENT

Cyber harassment is using computers, cell phones or other electronic devices to harass or intimidate someone. Examples include: posting negative comments, spreading rumors online, posting embarrassing photos and/or sending them via email or cell phone, or sending threatening/abusive messages.

HARASSERS BEWARE!

Any form of harassment is wrong. **It will not be tolerated at school.** Harassment is taken seriously and all complaints are completely investigated. Students who choose to harass another student can expect consequences which may include:

- in-school suspension
- parent contact
- parent conference
- verbal warnings
- police referral
- detentions
- out-of-school suspension

Prohibition Against Harassment and Discrimination Board Policy 5706

The Wausau School District prohibits bullying and hazing or the threat of such activities by a student or group of students against other students or personnel. The Board of Education considers these actions to be a violation of its obligation to provide a safe and healthful environment for all of its students and employees and determines them to be disruptive to the academic atmosphere.

BULLYING

Bullying is defined as the repeated intimidation of others by the real or threatened infliction of physical, verbal, written, electronically transmitted, or emotional abuse, or through attacks on the property of another. It may include, but is not limited to, action such as verbal taunts, spreading rumors, name-calling and put-downs, extortion of money or possessions, and exclusion from peer groups within the school. Such conduct based on race, ethnicity, disability, gender, or sexual orientation may contribute to harassment and discrimination in the school environment.

Students who engage in any act of bullying at school, at a school function, or in connection to any activity sponsored by the District, or while enroute to or from school, are subject to disciplinary action in accordance with Board Policy 5705, up to and including suspension or expulsion.

Students and employees shall be informed annually of this prohibition via the parent/student handbook, employee handbook, or other such publications. This policy shall not be interpreted to prohibit a reasonable and civil exchange of opinions or debate, which is protected by state or federal law.

HAZING

Hazing is defined as any intentional, knowing, or reckless act meant to induce physical pain, embarrassment, humiliation, deprivation of rights, or that creates physical or mental discomfort, or that results in property damage or theft, and is directed against a student for the purpose of being initiated into, affiliating with, holding office in (collectively called "initiation activities"), or maintaining membership in any organization, club, or athletic team sponsored or supported by the District and whose membership is totally or predominately other students from the District. Hazing is prohibited and applies to any and all student-sponsored and adult-sponsored activities that have not been approved by the District. An example of an approved school-sponsored initiation activity is the ceremony for the induction of students into the National Honor Society.

Students engaging in any hazing or hazing-type behavior that is in any way connected to any activity sponsored or supported by the District will be subject to disciplinary actions in accordance with Board Policy 5705, up to and including suspension or expulsion. Students and employees shall be informed annually of this prohibition via the parent-student handbook, employee handbook, or other such publications.

The School Board shall comply with the Wisconsin statutes that require school boards to provide an instructional program designed to give students knowledge of effective means by which they may recognize, avoid, prevent, and halt physically or psychologically intrusive or abusive situations that may be harmful to them. Any student who feels that he or she is the victim of bullying or hazing should contact the building principal or follow the complaint procedure provided in Board Policy 5405.

Students and others are prohibited from retaliating against those who report incidents of bullying or hazing or who assist in an investigation. Students and others who retaliate shall be subject to discipline.

Employees who participate in, allow, or knowingly fail to enforce this policy will be subject to disciplinary action.

Furthermore, as may be required by law, law enforcement officials shall be notified of bullying or hazing incidents.

ATTENDANCE PROCEDURES

Regular attendance at school during the full period and hours of the school day is required by state law. Under state law, ten days of excused absence from school are allowed for specific reasons, such as health or family emergency. Attendance is taken in each individual class. (WI statute 118.15)

**** Students are not allowed to leave school grounds without parental permission.**

EXCUSES FOR ABSENCE

When a student is absent for any reason, parents are asked to contact the Attendance Office before 9:00 a.m. and notify the attendance secretary of the reason for the absence. **Parents will be called at home or work after 10:00 a.m. to verify any absence if a phone call is not received.** If contact is not made with a parent or guardian, a written excuse must be brought to the Attendance Office within 48 hours of the student's return. This excuse must indicate the reason for absence and be signed by a parent. In some instances, upon the request of the school, a statement from a physician may be required explaining the cause of a student's absence. Any absence which has not followed the above procedure will be considered unexcused. **Students who are absent from school for the entire day will not be allowed to participate in after-school activities for the day they are absent. If a student returns to school for a part of that day, it will be at the administration's discretion as to whether that student may participate in any after-school activity.**

ANTICIPATED ABSENCES

Although students should be in attendance each day, sometimes absences can be anticipated. If parents know in advance that their child will be missing school, **an anticipated absence form** must be completed. Forms can be picked up in the Attendance Office. The student will have each teacher initial the form and indicate assignments that will be covered during the absence and arrangements for completing the work. Teachers will also indicate current academic status and possible effect the absence will have. The completed form is to be returned to the Attendance Office **before** the absence.

APPOINTMENTS DURING THE DAY

We would encourage parents to schedule medical, dental, or counseling appointments outside of the school day. When this is not possible, students are to report to the Attendance Office before first period with a note to get an **outside pass**. Students should also report there when they return to school. We expect students to return after the appointment.

TARDINESS

It is important that every student develop the habit of being on time. Tardiness disrupts classes and indicates a lack of concern and responsibility on your part. If you are more than ten minutes tardy to class, you will be considered absent from that class.

- a. If you are tardy because you arrived late from another class where the teacher held you, get your excuse from the Attendance Office.
- b. Students arriving late to school must check in and receive a pass from the Attendance Office. Students must have a note or phone call from a parent to be excused. If the student does not present a note or a phone call from a parent the student will be considered unexcused. Two or more unexcused tardies to school in one week will result in an after-school detention.
- c. Individual teachers will handle discipline for class tardiness. However, continued tardiness may be referred to the associate principal.
- d. Students who are continually tardy to school will be referred to the associate principal. Excessive tardiness will be considered truancy and the missed time will need to be made up by serving a detention.

ATTENDANCE PROCEDURES (continued)

TRUANCY

Truancy means any absence from school, class, or classes during which the principal or teacher has not been notified of the legal cause of such absence by the parent or guardian of the absent pupil. (WI statute 118.15 & 118.16)

Students will be required to make up all time missed for unexcused absences. For further information on attendance, please see the WSD Parent/Student Handbook.

Truancy Procedures are:

- a. The Student Assistance Team reviews students with truanancies and determines if absences are due to social or curriculum problems.
- b. Counselors will contact parents after the **third unexcused** absence in a given semester.
- c. Counselors will meet with students regarding their attendance after **eight days of absence** within a school year and/or after three unexcused absences in a given semester.
- d. A letter requesting a medical excuse for any future absences may be sent to the parents.
- e. If truancy continues, the associate principal will contact the parents and consider either issuing a formal referral to Juvenile Court Services or a Truancy Citation.

OTHER INFORMATION

BEHAVIOR AT ASSEMBLIES & PERFORMANCES

- Assemblies are scheduled periodically throughout the year and are designed to be an educational, as well as an entertaining, part of school activities. Regardless of the type of program, the courtesy of the entire student body is required. In live performances, the entertainers are very aware of their audience. Talking, whispering, stamping of feet, and booing are very discourteous and should not be heard during assemblies.
- Students will move to assemblies as directed by their teachers and will sit in an area assigned to them.
- Do not take books, coats, or other objects to an assembly unless instructed to do so.
- When the chairperson of the assembly asks for your attention, give it to him/her immediately.
- Be courteous to both the performers and your fellow students in the audience.
- Applaud in keeping with the occasion. Applause should be generous and courteous.
- Do not leave the assembly until you are dismissed.
- Students displaying inappropriate behavior will be taken to an assigned room and may lose the privilege of attending future assemblies.

CELL PHONES & TWO-WAY RADIOS

Cell phones are allowed but need to be turned off during the school day and kept in the student's locker. They are to be used before and after school only. Phones are not to be taken or used in the phy ed/athletic locker room areas. Cell phones displayed during the day will be confiscated and given to the Main Office staff. On the first incident, parents will be contacted, and the student will receive a verbal warning from Administration. If subsequent incidents occur, parents will be contacted, and a student will face disciplinary action.

No two-way radios will be allowed.

OTHER INFORMATION (continued)

ACTIVITY FEE

All students are required to pay a student activity fee at registration. The fee covers the cost of a student planner, some team-sponsored activities, assembly programs, and towel services for physical education.

BICYCLES



Bike racks are provided for you. In heavily congested areas (esp. around bus pick-up) you should walk your bike on the sidewalk to avoid collisions with pedestrians. Also, always remember to lock your bike securely to the rack and to obey all traffic laws.

SKATEBOARDS & ROLLERBLADES

Because skateboards and rollerblades on school grounds present an element of danger to walkers, drivers and riders, their use is not permitted on school grounds. Students violating this rule will have their skateboard or rollerblades confiscated. Students will be subject to disciplinary action.

FIRE/TORNADO DRILLS

Fire/tornado drills are required by law at regular intervals and are necessary for emergency preparedness. Fire/tornado drill regulations and exit routes are posted in each room. Students should familiarize themselves with the exit route from each classroom. Classroom teachers will review these regulations and direct students to the proper exit route.

VALUABLES

We STRONGLY recommend that:

TRADING CARDS
CD PLAYERS
IPODS
MP3 PLAYERS
ELECTRONIC DEVICES

not be brought to school. If brought to school, they may only be used before and after school and during students' lunch periods.

VISITORS

The school policy is to accept only those visitors who have legitimate business at the school. Parents, guests and visitors must register and receive a pass in the Main Office upon arrival. Persons in school without permission will be considered in violation of Wausau's city ordinance prohibiting loitering. Parents are always welcome and are requested to inform the teachers in advance when visiting classes.
Student visitors are not allowed.

FIELD TRIPS

Occasionally, a field trip or outing which is not curriculum-related is offered to particular grades or classes. In order to participate in such an activity, a student MUST complete and submit a parental permission form. These forms will be available at Schedule Pickup and in the Main Office. All students must have a signed Field Trip Medical Release form on file in the Health Office prior to any field trip. All trips are adequately chaperoned.

EMERGENCY CLOSING OF SCHOOL

Local radio and television stations will make announcements regarding any delayed school opening or school closing, so be sure to listen to your radio or television on inclement weather days. WSAU 550 AM and WIFC 95.5 FM are two of the many radio stations that carry these announcements.

OTHER INFORMATION (continued)

LOST AND FOUND

Students are urged to use extreme care with personal belongings and articles of value. Place identification on your property whenever possible. Items are to be turned in at the office. They will be kept in a bin across from the Main Office and can be claimed there by those who own the items. Articles of value will be kept in the Main Office. Items from the lost & found bins will periodically be donated to a charitable organization.

ACCIDENTS

Every accident in the school building, on the school grounds, or at any school-sponsored activity must be reported to the person in charge and to the school Health Services as soon as possible.

RECORDING DEVICES

Privacy and personal integrity are important at John Muir. **Do not** bring any cameras, video recorders, tape recorders or any other recording devices to school except for special occasions specified by the team and under the supervision of a staff member.

AUDITIONS

John Muir Middle School students can participate in a variety of different performance opportunities. Students can dance or sing in the annual **talent show** and/or try out for the **school play** presented late in the fall. These activities offer a wide range of singing, acting, and dancing experiences for students.

We believe in achieving a high standard of performance in our stage productions. Students must **audition** in order to take part in these activities. A student who auditions is **not** guaranteed a part in the show. We welcome all interested students, and we encourage those who have never performed to try out for one or all of these programs. Students need to remember that there are a limited number of openings in a cast - **parts will be given to those who show the most ability and potential in their audition.**

Many other elements are needed to make a stage performance successful. For students who may not get a performance role, there might be opportunities to join a make-up, lighting, costume, or stage crew. Any person who is not chosen for a performance part is encouraged to try out for another show in middle school, high school, or community theater.

Under the discretion of the director, all dress attire, behavior, performance material and actions must be approved.

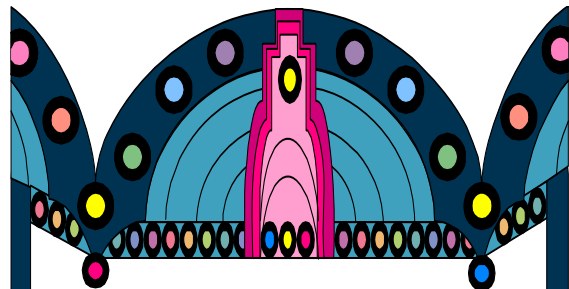

**NOW PLAYING
AT
JOHN MUIR
MIDDLE SCHOOL**

OTHER INFORMATION (continued)

7:35 A.M. WARNING BELL

All students are expected to be going to their homeroom at 7:35 A.M. A bell ringing at that time serves as a reminder. In addition to this warning bell, a bell will sound at the beginning and end of each period during the day.

<u>PERIOD</u>	<u>6th Grade</u>	<u>7th Grade</u>	<u>8th Grade</u>
0 (HR)	7:40-7:50	7:40-7:50	7:40-7:50
1	7:54-8:37	7:54-8:37	7:54-8:37
2	8:41-9:24	8:41-9:24	8:41-9:24
3	9:28-10:11	9:28-10:11	9:28-10:11
4	10:15-10:58	10:15-10:58	10:15-10:58
5	11:02-11:45 (lunch)	11:02-11:45	11:02-11:45 (SOAR)
6	11:49-12:32	11:49-12:32 (SOAR)	11:49-12:32 (lunch)
7	12:36-1:19	12:36-1:19 (lunch)	12:36-1:19
8	1:23-2:07	1:23-2:07	1:23-2:07
9	2:11-2:55 (SOAR)	2:11-2:55	2:11-2:55

HALL PASSES

Students are not permitted in the halls during class periods unless they are accompanied by a staff member or have a hall pass from an authorized staff member.

BULLETINS & ANNOUNCEMENTS

Announcements are broadcast live every day at 7:40 a.m.

TELEPHONES

The office telephone is a business phone and not for student use. There is a pay telephone located in the hallway outside of the auditorium. This phone is to be used when students need to make arrangements for after-school activities. For non-emergency calls, students are encouraged to use the call-home-collect service if they don't have money for the pay phone.

Telephone messages from parents to students should be of an emergency nature.

Contact the Attendance Office to send a message to a student. An announcement will be made at the end of the day for the student to come down after school to receive the message. Only messages determined by the school to be of an **emergency** nature will be delivered to students. Each time a message is delivered, it disrupts the class and learning.

BUILDING HOURS

During the school year, the building will open at 7:15 a.m. for students participating in our breakfast program. These students must enter the building through the west cafeteria doors and remain in the cafeteria until the 7:30 a.m. bell. After 7:30 a.m., students may enter the building through the Stewart Avenue or the Callon Street entrances.

The student's day begins at 7:40 a.m. and dismissal is at 2:55 p.m. **ALL STUDENTS ARE EXPECTED TO BE OUT OF THE BUILDING BY 3:15 P.M. UNLESS UNDER THE DIRECT SUPERVISION OF A STAFF MEMBER, INVOLVED IN AN AFTER-SCHOOL ACTIVITY, OR ASSIGNED TO THE DETENTION ROOM.**

The administrative offices are open between the hours of 7:15 a.m. and 4:00 p.m. The instructional staff hours are 7:30 a.m. to 3:30 p.m. During vacation periods, the administrative office hours are 7:30 a.m. to 3:00 p.m. The office will be closed on Fridays from June 18 through August 6. Summer office hours are Monday through Thursday, 7:30 a.m. to 3:00 p.m.

SECURITY CAMERAS

John Muir uses video surveillance as a deterrent for inappropriate activity. Due to student confidentiality and privacy laws, administration and law enforcement will be the only individuals allowed to view security tapes from these cameras.

OTHER INFORMATION (continued)

DANCES & STUDENT COUNCIL SPONSORED ACTIVITIES

Part of the middle school philosophy is to provide an atmosphere and activities to assist students with appropriate social development.

The Student Council sponsors seventh and eighth grade dances during the year and other after-school activities for all grade levels (swimming, volleyball, basketball, dancing).

These activities are only for John Muir students, and they are from 3:15—5:30 p.m.

- **For the after-school activities, students must arrive by 3:30 p.m. For evening dances, students must arrive by 7:30 p.m. They must remain until 9:00 p.m.**
- Students leaving are not permitted to return.
- Students who have been involved in serious or frequent discipline matters, including in-school or out-of-school suspension, will not be allowed to attend such functions. Discipline actions resulting in referral to the School Resource Officer will result in students not being allowed to attend these functions. All situations, including poor attendance and chronic unexcused tardies, will be reviewed by administration.
- **After evening dances, students are to be picked up by 10:00 p.m.** If students are not picked up at the required time, they must be accompanied by a parent/guardian in order for them to attend the next activity.

TEXTBOOKS

All books and instructional materials are the property of the Board of Education and the Wausau Public Schools. Students are expected to take proper care of these books and are responsible for returning them to the person by whom they were issued. Students will be held responsible to pay for damages beyond reasonable wear. Lost books will be paid for by the student to whom it was issued.



COMMUNICABLE DISEASE POLICY STATEMENT

The health and safety of students and staff will be the primary consideration in dealing with communicable disease. The Wausau School District employs two co-administrators of School Health Services. The administration will contact these resources and legal authorities if necessary when there are concerns related to a communicable disease.

It is the responsibility of staff members to report any suspected or diagnosed communicable disease to the Health Services office and principal. Necessary precautions will be taken. Reportable diseases must be reported to the Health Department per Wisconsin Statute Chapter 143.04(3). Confidentiality of a student or staff member shall be maintained in compliance with State Statute 118.125. However, appropriate staff members will be informed of related risks and necessary precautions. An alternative educational plan will be implemented for students who must be restricted from the routine school setting for a significant period of time.

An alternative employment plan may be implemented for staff who must be restricted from the routine school setting for a significant period of time. The employees' master agreement will be adhered to with the understanding that state and federal statutes will take precedence.

OTHER INFORMATION (continued)

GRADING/HONORS

- Students may receive the following grades to indicate student progress: A, B, C, D, F, M, S, or U. Teachers also add comments to give the student and parent an understanding of the assigned letter grade. Grading scale: 100% = A+; 93-99% = A; 90-92% = A-; 87-89% = B+; 83-86% = B; 80-82% = B-; 77-79% = C+; 73-76% = C; 70-72% = C-; 67-69% = D+; 63-66% = D; 60-62% = D-; and 0-59% = F.
- Report cards evaluating achievement and effort will be given to each student at the end of each quarter.
- At the middle of the quarter, progress is reported with a progress report.
- Parent-Teacher conferences will be scheduled twice a year. Parents may request a conference at any time during the school year by contacting any of the student's teachers.
- Academic Excellence - The Board of Education has approved the concept of recognition for academic excellence. Under the following criteria, certificates will be awarded on a semester basis: Highest Honors, 3.75 - 4.00; High Honors, 3.50 - 3.74; and Honors, 3.25 - 3.49.
- Principal's Honor Roll - Each grading period special recognition is given for all A's.

President's Award for Educational Excellence - The purpose of this award is to recognize and reward educational excellence. Students must earn a 3.5 cumulative GPA through their middle school years. They must also have achieved in the Advanced Level in math and/or reading on WKCE test taken in 8th grade.

President's Award for Educational Achievement - The purpose of this award is to recognize educational achievement. Students must earn a 3.5 cumulative GPA or better through their middle school years and achieve the Proficient level in reading and/or math on the WKCE test taken in 8th grade or one or more of the following:

- demonstrates unusual commitment to learning in academics despite various obstacles
- shows outstanding growth, improvement, commitment to, or intellectual development in an academic area
- demonstrates achievement in the visual or performing arts

Citizens of the Month - Each month, three students from each team will be selected as Citizens of the Month by their team teachers and the related arts teachers. Selection is based on the students who:

- speak kindly to others
- respect others' feelings, opinions, and rights
- treat people with courtesy
- stand up for what is right/fair
- help others
- take responsibility for their actions

N.E.T. (Newer Educational Techniques) - Students who fail a class in any quarter are required to attend an after-school study program called N.E.T. for the following quarter. The program is staffed by a teacher and is held Mondays, Tuesdays and Thursdays from 3:00 to 4:00 p.m. Parents will need to arrange transportation for their child.

Failures - Students who fail two or more core classes in a year, and do not complete N.E.T., will be required to attend Summer School and successfully complete it.

PHYSICAL EDUCATION REQUIREMENTS

All students will meet three times a week for physical education. A towel fee is charged at the start of the school year which is included in the activity fee.

1. Students can wear their own gym shorts, wind pants, or sweatpants, but must wear a school t- shirt and gym shoes. Shirts are sold through the Phy. Ed. Department. Students will write their first and last name on the front and back of their shirts so lost shirts can be returned easily. No other alteration or ornamentation on the gym shirt is acceptable.
2. It is important to regularly launder all gym clothes. However, students must have the required apparel for **every** class.
3. Showers and towels are available for use after class.
4. Students must furnish their own swimming suits (no bikini style) appropriate for class activities.
5. For the purpose of school safety, all students are required to purchase a school lock through the Physical Education Department. No other key or combination lock will be allowed. **Students are responsible for locking their locker.** The school is **NOT** responsible for lost or stolen articles.
6. Title IX of the 1972 Educational Amendments requires schools to offer equal opportunity for girls and boys in physical education.
7. Students will complete all class or swim make-ups as required by their physical education teacher.
8. Instructors expect students to perform to the best of their ability each day in class. Any student well enough to attend school is expected to dress and perform in class. Students need to inform their instructor of any situation that may affect their performance. Any student who needs to be excused from physical education for any period of time must have a note from his/her physician.

COMPUTER USE/MISUSE

We are fortunate to have many computers available for students. The computer lab, technology lab, the IMC, the writing lab and many classrooms have computers for student use. We expect students will use computers appropriately. Parents must notify the school if they DO NOT wish their child to have access to the Internet.

Students who use another's password, install programs on hard drives, change screen colors or screen savers, access hard drives through file managers, i.e., use the computer in any way that is not within the proper use of the computer, may be denied use of computers. In addition, serious problems may result in paying for a consultant's time to repair damage and/or suspension from school.

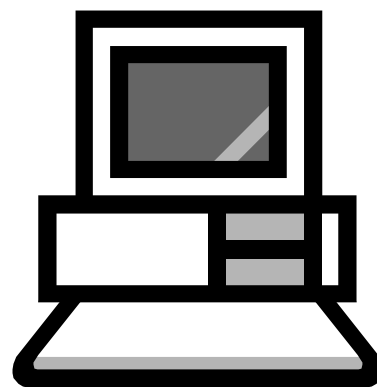

STUDENT CONDUCT

CLASSROOM BEHAVIOR

Each teacher and team is responsible for enforcing individual classroom guidelines. Usually, these include being on time for class, respecting others' rights, bringing the appropriate materials, participating with the class activities, dressing appropriately, and treating school property with care.

Teachers will use the following options for students not following classroom guidelines:

1. Verbal warning
2. Teacher contacts parent/guardian
3. Conference with student and counselor, if necessary
4. After-school detention with teacher (parents notified)
5. Referral to administration

Occasionally, a student persists in disrupting a class to the extent that he/she must be removed from the classroom. The staff at John Muir Middle School expects students to behave appropriately and not to interfere with other students' rights to learn. When students choose to disrupt the learning atmosphere in a classroom, they are interfering with other students' education. **The staff strongly believes that students disrupting classes cannot and will not be tolerated at John Muir Middle School.**

When a referral is made to an administrator, a range of consequences may result including any of the following: a discipline-conduct referral, a noon hour detention, an after-school detention, an in-school suspension, an out-of-school suspension, or possibly a referral to the building's School Resource Officer.



PUBLIC DISPLAYS OF AFFECTION (PDA)

The school recognizes that genuine feelings of affection may exist between students; however, students shall refrain from behaviors such as hand-holding, hugging, and kissing on campus or at school-related events. Repeated or especially inappropriate behavior in this regard may result in disciplinary consequences.

DETENTION - AFTER SCHOOL

Students that are assigned an after-school detention for classroom related problems will serve the detention with the teacher that issued the detention. Students that are assigned detentions by an administrator or for problems outside of the classroom will report to a designated room to serve the detention. The following guidelines are to be followed for students serving detentions:

1. Students are to report by 3:00 p.m.
2. Students are to report with work to complete.
3. Students will be assigned a seat and are to remain quiet.
4. All building rules are in effect.
5. Continued violation of the detention rules or failure to report may result in additional detentions or suspension. Students will have prior notice before serving detentions in order to make transportation arrangements. **Parents are responsible for picking up their child after serving a detention.**

STUDENT CONDUCT (continued)

LASER POINTERS

No lasers are permitted at school. Lasers will be confiscated and students may be subject to disciplinary action.

TOBACCO PRODUCTS

Students are not permitted to possess or use tobacco in the building, on the school grounds, or within the area immediately surrounding the grounds. Also, students in possession of related smoking materials, such as matches or lighters, will be in violation of this policy. Violation is a serious offense and will result in an in-school or out-of-school suspension of up to three days and/or a municipal citation. **John Muir is a Tobacco-Free Zone!**



LOCKER POLICY

Lockers are made available for student use in storing school supplies and personal items necessary for use at school. They are not to be used for any other purpose without prior approval. **STUDENTS ARE TO KEEP THEIR ASSIGNED LOCKER UNLESS IT IS CHANGED BY THE ISSUING TEACHER OR THE OFFICE.** Students will also choose a locker in the locker room. This locker will be used to store Phy. Ed. clothes. Students must purchase a lock from the Phy. Ed. Department. No other locks are allowed on any locker. The lock can be used here as well as at the high school. **The school is not responsible for anything taken from your locker. If you value your personal possessions, keep your locker locked and give your combination to no one!** Students are not allowed to use any other student's locker. The hall locker and Phy. Ed. locker are the property of the school and are provided for student use. The locker is not the student's private property and may be opened and inspected by school administrators at any time, for any reason including searching for stolen items, weapons, drugs, or other items which place students or staff in danger. School personnel may take possession of any item in a locker (as well as overdue library books) which violates Wisconsin law or school rules.

JUVENILE CITATIONS

The Wausau City Council, in accordance with the Wisconsin State Statutes, has revised its bond schedule. The majority of our students are old enough to receive citations/fines for breaking laws within the schools. Examples of incidents where citations may be issued include theft, smoking, possession of cigarettes or tobacco, throwing snowballs, profane language, fighting, and disorderly conduct. The revised statute also means a mandatory court appearance where the judge sets the fine amount. We want students and parents to be aware that this is another option in disciplining students who choose to disrupt the school atmosphere.

EXPECTATIONS OUTSIDE THE CLASSROOM

Our staff expects that students will conduct themselves appropriately when they are not in class. While in the hallways and other non-classroom areas, students are expected to:

- walk safely
- respect other's personal and property rights
- use appropriate language
- refrain from spitting
- talk pleasantly and at a volume that will not disrupt classes that are in session
- have a pass from the appropriate teacher
- not have open beverages, other than water

The following may happen for not following these guidelines:

1. Verbal Warning/Disciplinary Action
2. Parent Notification
3. After-School Detention (parents notified)
4. Referral to Associate Principal

UNSAFE ACTIONS

Any student whose actions threaten the safety of another student may be suspended from school. Examples include fooling around, horseplay, repeating rumors that one student wants to beat up someone else, or encouraging others to fight. We expect our students to take actions to prevent their fellow students from being hurt.

SELLING/SOLICITATION

There is to be no selling or solicitation of any items by students at school without receiving prior approval from the principal.

FIREWORKS

Students are not to bring any firecrackers or fireworks of any sort to school. Students who choose to bring these items will be referred to the School Resource Officer and/or suspended from school.

STUDENT CONDUCT (continued)

SUSPENSION/EXPULSION

Every student has the right to attend the Wausau School District without fear of being threatened or harmed in any way, either physically or verbally. In order to make this goal a reality, the school administration at the Wausau School District will enforce the following consequences for rule violations.

An in-school or out-of-school suspension for a period of 1-5 days may be issued by the building administrators for any of, but are not limited to, the following reasons (WI statute 120.13):

- a. When there is a reasonable cause to believe that the physical safety of the student or others is endangered.
- b. The student is causing, and will continue to cause, substantial interference with normal classroom activity and instruction.
- c. The student intentionally causes, or attempts to cause, substantial damage on private or school property.
- d. The student steals, or attempts to steal, private or school property.
- e. The student intentionally causes, or attempts to cause, physical injury to another person, except in self-defense.
- f. The student knowingly possesses, uses, transmits, or is under the influence of any substance including alcohol, drugs, inhalants, amphetamines, marijuana, barbiturates, intoxicants of any kind, or any chemical or controlled substance prohibited under state or federal law.
- g. Smoking or possession of any smoking related materials including matches, lighters, tobacco or cigarettes during school or on the school campus.
- h. The student repeatedly and willfully defies the valid authority of supervisors, teachers, or an administrator or repeatedly violates rules regulating policy in the school code.
- i. The student is verbally abusive.
- j. The student verbally, physically, or sexually harasses or intimidates another person.
- k. The student fails to identify himself to a staff member.

Students may be recommended to the Wausau Board of Education for expulsion from the Wausau School District for the following behaviors at school or school-sponsored activities:

- a. Starting or attempting to start a fire on school premises.
- b. Disrupting the school environment through the use of violence.
- c. Acting in a way that threatens the life or health of another person where such conduct is considered criminal by federal, state or local laws.
- d. Sexually assaulting another person.
- e. Setting off of the school's fire alarm system or falsely reporting a fire when no fire exists.
- f. Making a bomb threat or placing a false alarm call.

Students will be recommended to the Wausau Board of Education for expulsion from the Wausau School District for the following behaviors at school or school-sponsored activities:

- a. Possession of a gun.
- b. Possession of a dangerous weapon with intent to threaten or cause bodily harm to others or to cause property damage.
- c. Possession of, under the influence of, selling, dispensing or delivering drugs or chemicals which Wisconsin statutes define as illegal.
- d. Intentional use of unprovoked force against a Wausau School District employee.

The above information includes reasons for suspension and expulsion. For complete procedures before a suspension is made, procedures once a suspension decision is made, information on repeat offenders, and expulsion procedures, see the WSD Parent/Student Handbook.

STUDENT CONDUCT (continued)

STUDENT DRESS AND APPEARANCE

John Muir takes pride in the appearance of its students. Students' attire reflects the quality of the school, conduct, school work and the general atmosphere of the school. We expect at all times that students will dress and groom themselves appropriately for school. It is expected that such dress will not be disruptive to the learning process. Responsibility for the personal appearance of students enrolled in the Wausau School District shall normally rest with the students themselves and their parents/guardians. Student dress or grooming shall not, however:

- a. affect the health or safety of students; or
- b. disrupt the learning process within the classroom or school.

In order to assure a healthy and safe school environment for students, the following student dress code guidelines will be enforced:

1. During the school day, hats, caps, bandannas, head coverings and jackets shall be taken off and placed in the student's locker soon after the student enters the building. These items shall not be worn in the classroom, and they shall not be worn in the school building except when the student has immediately entered or is leaving the building or as part of Spirit Days.
2. No student shall be permitted to wear any clothing that contains pictures and/or writing referring to alcoholic beverages, tobacco products, sexual references, profanity, promotion of gambling, illegal drugs and/or gangs, race/ethnic groups or gender.
3. Medallions or other jewelry which identify gang members or gang affiliation or which have come to represent a gang shall also not be worn or displayed in school or at school events. Also, gang clothing is not always restricted to an item of clothing, but may include the way in which a particular item of clothing is worn. No gang insignia may be worn, possessed, used, distributed, displayed, carried or sold by any student on school grounds or at school-related activities at any time. The reference to "gang insignia" would also encompass items of clothing that signify gang activity by the manners in which they are worn.
4. Appropriate clothing is expected. No skirts, shorts or dresses shorter than mid-thigh, regardless of leggings or clothing underneath. Holes in clothing above mid-thigh will not be accepted. Low-cut tops, bare midriffs, halter tops, form-fitting clothing and spaghetti-strap tops are not allowed. Bra straps, boxers, or any other type of underwear must not be exposed. Shoes are to be worn at all times.
5. Wallet chains are not allowed and heavy necklace chains are subject to review by staff.

This code is not intended to limit the right of the building and/or district administration to establish rules or restrictions regarding other paraphernalia or dress that disrupts or threatens to disrupt the learning environment of any school. If there is a disagreement between students and/or parents and the staff regarding the appropriateness of clothing or other paraphernalia, the principal will use his/her discretion to make the final decision.

Students who violate the rules will be subject to the collection of the inappropriate items and/or sent home by the administration for appropriate wearing apparel. A parent conference will be called to return inappropriate items. Repeated violations of school rules may constitute grounds for suspension or other appropriate action to correct the situation.

STUDENT SERVICES

INSURANCE

The school district does not carry health or accident insurance for its students. Information describing a commercial insurance program which covers school activities will be available at Schedule Pickup or in the Main Office. Parents may purchase this coverage if they desire.

HEALTH SERVICES

Illness at School

Students who become ill during school hours must report to the Health Office **before** leaving the building. Students **may not** call parents from their classrooms or use a cell phone.

Medication at School

Students may receive prescription medication during school hours with a Prescription Medication Consent form completed and signed by parent and practitioner. The medication must arrive in the **original container** brought in by an adult. The school is not able to give medications that are not FDA approved or dispense medications brought in baggies or envelopes.

If a student needs an over-the-counter medication, a Prescription Medication Consent form, signed by the parent, is needed. If a student requires a different dose than what is written on the medication bottle, a parent and practitioner needs to sign the consent and bring the medication in its original container.

Students may carry and self-administer life-saving medication with a Prescription Medication Consent form completed and signed by parent and practitioner. These medications would include a rescue inhaler, glucagon, or epinephrine pen. These medications must have a pharmacy label.

Students may also carry and self-administer cough drops/throat lozenges, lip balms, and sunscreens. (No forms are needed.)

Medication forms can be found in the Health Office or on the Wausau School District home page at <http://www.wausau.k12.wi.us> under Parents, Students, and Community.

If you have any questions, don't hesitate to call the Health Services Office at 715-261-0125.

COUNSELING

The counselors are available for all students at John Muir. The counselor that you have the first year at John Muir will continue on with you through all three years of middle school. It may be helpful to seek the aid of a counselor for any of a variety of reasons.

To help you, the counselors may do the following:

1. Engage in personal and confidential counseling with you, an individual student.
2. Refer students with special needs, interests, or problems to others who can help.
3. Assist teachers in arriving at a better understanding of the capabilities and limitations you have as an individual student.
4. Interpret tests and other evaluation procedures for you.

All students are welcome in the Counseling Offices. Just stop in at any time.

IMC

More than 25,000 volumes, plus reference books and periodicals, make up the resources of our media center. Students are urged to use the library for reference and resource materials and for keeping up to date with the latest information in all fields. IMC hours are from 7:40 a.m. until 3:30 p.m. The IMC may be used during your team study or during other times arranged with your classroom teachers.

SCHOOL RESOURCE OFFICER

The Wausau Police Department, in cooperation with the Wausau School District, has a police officer that works part-time at John Muir Middle School. The Resource Officer can be contacted through the Main Office at John Muir. The officer handles police referrals at John Muir and also serves as a resource person in the classroom. Students wishing to see the officer may go to the Main Office. John Muir's Resource Officer is Detective Mary Wogernese. For further information, see Board Policy 5132.

STUDENT SERVICES (continued)

STUDENT COUNCIL

Officers of Student Council are elected from the seventh grade class in the spring to serve as our eighth grade leaders the following year. The purposes of the Student Council are to develop leadership abilities in the students, to give the students a sense of participation in government, to promote social activities, to set good examples for the entire student body and to improve student-faculty relations.

The 2011-2012 Student Council members are:

President - Lillian Battino
Vice President - Maggie Hall
Treasurer - Madeleine Mayer
Secretary - Aaron Schmidkofer

STUDENT SUPPORT PROGRAM

John Muir Middle School has a Student Support Program (SSP) to meet the needs of students who may have various problems that interfere with their learning.

One of the groups is a "concerned persons" support group for students affected by alcohol or drug use by close family or friends. Other groups that have been utilized are grief, divorce, friendship and anger management. These groups help the students deal with stressful issues in their life and, at the same time, let them see that they are not alone.

All groups are coordinated through the Counseling Office. Participation is voluntary. Information that is shared in the groups is confidential. Each group is lead by the grade level counselor. Groups meet weekly for 6-8 weeks during their team study.

JOHN MUIR VOICE MAILBOX

715-261-0100 Main Switchboard	715-261-0155 Activities & Announcements
715-261-0110 Attendance	715-261-0156 Lunch Menu
715-261-0125 Health Services	715-261-0115 Counseling

TRANSPORTATION

State law requires that school districts provide bus transportation for pupils who live more than two miles from their school. Except for special education and handicapped students, the Wausau School District, for financial reasons, will not provide free bus transportation for students within the two mile limit. It shall be the policy of the Wausau School District that the maximum walking distances to a school bus stop outside the Wausau city limits is 1/2 mile for middle school students. This policy applies to all students except for special education students.

Who can ride?

- A. Only students assigned to a bus may ride that bus.
- B. Students may only be picked up and dropped off at their assigned stop.
- C. A request to be picked up or dropped off at any other place **MUST** follow this procedure:
 1. A note from the parent must be taken to the associate principal of your school.
 2. The associate principal may sign the note giving permission for the change.
 3. The note must be given to the driver when boarding the bus.
 4. If a student rides a different bus, the driver will only take the student if there is a seat on the bus (This should be cleared with First Student Bus Company at 715-842-2268 before the associate principal signs the note.)
 5. The following information must be on the note: date note was written, place you wish to get off, day and date this change will take place, reason for change, and parent's signature.
- D. Student School Bus Pass must be shown to the driver when boarding the bus.

BUS RIDER RULES

1. No littering on the school bus.
2. Use proper boarding/departing procedures.
3. Do not use unnecessary loud, boisterous sounds, yell, be rude, discourteous or annoying.
4. Remain seated at all times except when boarding or departing the bus.
5. Do not eat/drink on the bus without the driver's permission.
6. Do not have parts of your body hanging out of windows.
7. Do not use improper language/profanity/gestures.
8. Do not throw objects in, at or out of the bus.
9. Do not engage in behavior that abuses the safety, well-being and respect of others on the bus or at the bus stop.
10. Do not push, trip, kick, hit, bite or spit.
11. Do not disobey instructions of, and/or show disrespect to, the bus driver.
12. Do not bring illegal/dangerous articles/substances and/or weapons on the bus.
13. Do not light matches, use lighters or possess or use tobacco products.
14. Do not tamper with bus equipment or destroy property.
15. Do not engage in sexual misconduct/harassment.
16. Do not fight or engage in violent behavior.
17. Do not use behavior that requires the bus driver to pull over in order to preserve the safety of others.

EXTRA CURRICULAR TRIPS

- A. The Bus Rider Rules apply during any trip under school sponsorship.
- B. Pupils shall respect the wishes of the chaperone.

DISOBEYING BUS RIDER RULES

The following will be used for students who cause problems on the bus:

- A. A verbal warning by the driver will be given to a student breaking the rules.
- B. When the student continues to break the rules, the bus driver will write a "School Bus Misconduct Report."
- C. 1st offense: Letter sent to parents.
2nd offense: Letter sent to parents & student/principal conference. 3-day suspension from riding.
3rd offense: Conference with parents & 10 day riding suspension.
4th offense: Conference with parents & balance of year riding suspension.
- D. Any steps may be bypassed depending on the seriousness of the offense.

LUNCH PERIOD PROCEDURES

All students at John Muir are expected to assist in maintaining the cleanliness of our cafeteria. Students will be placed on a rotation, which will require them to assist in the clean-up process for a period of one week during the school year. During the week rotation, students have the privilege of going first through the lunch line. Students still have the opportunity for recess time.

DISMISSAL

Students must report to the cafeteria with coats and other appropriate weather apparel. Students will not be permitted in the classroom section of the building during their lunch period unless they have a pass from a faculty member or are under the direct supervision of a staff member.

CAFETERIA RULES and EXPECTATIONS

1. Students are required to eat their lunch in the cafeteria unless that privilege has been taken away or other arrangements have been made with a staff member.
2. Students are expected to behave in an orderly manner. Running, shouting, pushing, littering, line cutting, fighting, needless changing of seats, throwing food and other unsanitary, disrespectful or dangerous behavior will not be allowed.
3. Students are to remain seated until they have finished eating.
4. After cleaning up the table and floor, students are to raise their hands to be excused to take their trays to the dishwasher's window.
5. When finished eating and cleaning up, students will be expected to go outdoors, weather permitting. All students not going outside will be expected to be involved in quiet activities.
6. Students may use the bathrooms by the cafeteria, but they are not to go anywhere else in the building without a pass.

OUTSIDE REGULATIONS DURING LUNCH PERIOD

1. Students leaving the building must leave by the cafeteria exit doors.
2. Students leaving the building will not be permitted to re-enter until they are directed to re-enter by the lunch period supervisors.
3. Students are to remain in the fenced playground area or on the field, if supervision is available.
4. Only safe, sanitary, respectful behavior is allowed. Lively play during games is expected, but rough or overly aggressive behavior is not allowed.
5. Students are expected to follow directions given by the playground supervisors. (Playground supervisors wear yellow vests.)
6. During outdoor winter recess, students are expected to make good choices and not be involved in rough play with snow and ice to include no throwing or kicking snow or ice. Students are not permitted to play on snow piles or ice patches due to safety concerns.
7. All food and drink must be consumed in the cafeteria before going outside. (NO FOOD/DRINKS OUTSIDE!)

CLOSED CAMPUS

1. Students are not permitted to leave the campus without parental permission.
2. Students leaving campus to go home during the lunch period must have a permission slip from their parents on file with the associate principal. If the student who has permission to go home for lunch abuses this privilege, permission to go home will be taken away.

8TH GRADE PROMOTION POLICY

The Wausau School District recognizes the importance of continual academic progress for its students. Measurable evidence of student progress toward the District's grade-level benchmarks is expected in order for a student to advance from one grade level to the next.

ACADEMIC PERFORMANCE CRITERION

- ⇒ Show evidence of academic growth towards achieving the WSD grade-level benchmarks. Eighth grade students must demonstrate growth by achieving passing grades in the content areas assessed on the WKCE.
- ⇒ A proficiency score of Basic, Proficient or Advanced on each of the academic growth areas assessed on the WKCE and a holistic score of 3.0 or higher on the writing assessment.

ACADEMIC PERFORMANCE INDICATORS

- Passing grades in the eighth grade in the deficient content area(s).
- Satisfactory completion of a summer school program in the deficient content area(s).
- A cumulative grade point average of 2.0 in all courses taken in the eighth grade year.
- Satisfactory completion of an academic support program.
- Satisfactory completion of all expectations identified in the student's academic action plan as recommended by the Student Assistance Team.
- Satisfactory performance on Wausau School District performance assessment in the deficient content area(s).

TEACHER RECOMMENDATION

Recommendation of committee consisting of the student's eighth grade teachers in the content areas assessed on the WKCE, one teacher representing another content area, guidance counselor, school psychologist, associate principal and any other licensed staff members the committee deems necessary.



ACADEMIC HONESTY

John Muir Middle School regards academic honesty as a cornerstone of its mission. It is expected that all schoolwork submitted as a class requirement represent the original efforts of the student. Teachers, students, administrators, and parents are all important contributors to maintaining academic integrity at school. All forms of academic dishonesty are unacceptable!

Some examples of academic dishonesty include:

- Cheating on quizzes, tests, exams (giving or receiving unauthorized help)
- Plagiarism (using someone else's work, words, or ideas and claiming they are your own)
- Copying someone else's homework or other work
- Allowing your work to be copied
- Making up information, data, and/or citations
- Group work on individual assignments
- Forging information and presenting it as authentic or real
- Turning in the same work in multiple classes (projects or research papers) without prior teacher permission
- Having another person complete assignments or other work
- Completing another person's homework or assignments
- Purchasing or selling papers/assignments/homework
- Use notes or reference materials in an unauthorized way (cheat sheets; electronic means)
- Failure to follow a teacher's test-taking procedures

Students who are academically dishonest will be required to make up the class work or test to ensure an accurate assessment of the student's proficiency and skill level. Students will also be subject to disciplinary action.

HOMEWORK

The Wausau School District believes:

- That the mastery of basic skills is essential for a sound education.
- That not all students will be able to attain mastery of skills during the school day.
- That meaningful practice over a period of time will be necessary to attain mastery learning.
- That homework allows students an opportunity to explore educational experiences beyond the classroom.
- Therefore, it is both appropriate and necessary for students to be assigned some homework. It is the intent of the Wausau School District to encourage standards of homework that will maximize it as a meaningful and reinforcing part of the students' program of learning.

Visit John Muir's website and locate Team WIKI pages for assignments.

If you are on Team 8-2, you may also call 715-261-0112 for assignments.



Final Draft Requirements

Handwritten

1. Write first and last name, subject, class period, and date in upper right-hand corner.
2. Use white loose-leaf paper with no fringes.
3. Write neatly in dark blue or black pen.
4. Use White Out sparingly.
5. Leave margins of 1" at each of the four sides of your paper.
6. Center your title on the top line of your paper.
7. Skip one line after the title.
8. Indent the first line of each paragraph, and do not skip lines between paragraphs. *If using block style (no paragraph indentations), skip one line between paragraphs.*
9. Use complete sentences. Proofread for proper grammar and clarity.
10. Use correct conventions (i.e. capital letters, punctuation and spelling).

Word Processed

1. Write first and last name, subject, class period, and date in upper right-hand corner.
2. Use white printer paper.
3. Use Times New Roman font, size 12 or 14, in black ink. Double space the text.
4. No cross outs of text.
5. Leave margins of 1" at each of the four sides of your paper.
6. Center your title on the top line of your paper.
7. Skip one line after the title.
8. Indent the first line of each paragraph, and do not skip lines between paragraph. *If using block style (no paragraph indentations), skip one line between paragraphs.*
9. Use complete sentences. Proofread for proper grammar and clarity.
10. Use correct conventions (i.e. capital letters, punctuation and spelling.)

Marathon County Crimestoppers, Inc.

Quick \$50

Completely
Confidential!



Help Get Alcohol, Drugs and Weapons OUT of our Schools

To Remain Confidential:

Report information directly to a School Official or Liaison Officer

To Remain Anonymous,

Text, call or send a web-tip to Marathon County Crime Stoppers

You may earn a \$50 cash reward for Confirmed tip information

1-877-409-8777

marathoncountycrimestoppers.org

WAUSAU SCHOOL DISTRICT MIDDLE SCHOOL MISSION STATEMENT

The mission of the Wausau middle school is to provide a comprehensive educational program in a safe and nurturing environment appropriate to the emotional, intellectual, social, and physical needs of adolescents.

BELIEF STATEMENTS

WE BELIEVE THAT MIDDLE SCHOOL STUDENTS

- need supportive family environment and positive adult role models.
- need to develop a positive self-image.
- need to develop understanding, appreciation and respect for individual differences.
- need to have support, encouragement and the opportunity to explore and diversify.
- need a safe environment.
- need parental involvement in the students' education.
- need to be provided with opportunities and recognition for success.
- need structure, consistency and accountability for their academic, social and behavior growth.
- need to develop an acceptance and awareness of their own and others emotional, intellectual social and physical development.
- need positive social relationships.
- need to have opportunities to develop visions for their futures.
- need to view themselves as contributors to what happens in their lives.

We believe that all students can learn.

We believe the middle school environment needs to be age appropriate.

We believe middle school students have a developing self-concept.

WANT STATEMENTS

WE WANT ALL STUDENTS TO

- develop decision making and problem solving skills.
- be proficient in expressing and using ideas.
- become lifelong learners.
- develop an appreciation for the arts.
- be proficient in reading, writing and other communication skills.
- be positive contributors to society.
- develop understanding, appreciation, respect of our multi-cultural society and world.
- become independent thinkers who are confident and willing to participate in group dynamics.
- understand the importance of success and that there are different levels of success.
- accept responsibility for their actions.
- develop enthusiasm for learning.
- develop pride in their effort.
- develop a healthy lifestyle.
- develop and maintain a positive self image.
- be caring and respectful of self and others.
- develop individual accountability, responsibility and pride in their work.
- develop an awareness of life's work opportunities.
- be in a supportive and safe environment.

RESEARCHED-BASED KNOWLEDGE STATEMENTS

MIDDLE SCHOOL STUDENTS

- are developmentally different from elementary and high school students.
- experience mood swings, growth spurts, and periods of high and low energy levels caused by hormonal changes.
- search to establish positive social relationships with both boys and girls.
- begin to develop skills of reflecting, hypothesizing, and organizing.
- wonder about their future.
- are idealistic.
- experience physical changes that may create embarrassment.
- demonstrate increased interest in the social, emotional, and physical aspects of their lives.
- prefers peers rather than adults to establish criteria for social acceptance or rejection.
- primary social goal is to achieve recognition and esteem from peers.
- self-concept emerges through peer responses and self-perception.
- may harbor feelings of inferiority.
- friendships change often as they seek identity through others.
- may have a short attention span.
- need the support of an adult with whom they can share experiences while asserting their independence.
- challenge authority.

Primary physical changes in boys take place about twelve to eighteen months later than corresponding changes in girls.

Education is important when it is relevant to their personal life and immediate environment.

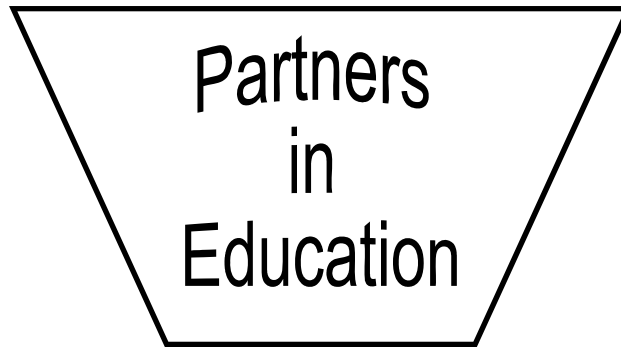

Student's Pledge

I will

- be respectful, responsible, and follow the rules.
- be accountable for my actions, attitude, and academics.
- perform to the best of my ability.
- discuss my school activities with my parents/guardians.

Educator's Pledge

I will

- be respectful and responsive to every child.
- treat all students fairly and set them up for success.
- be prepared to teach and engage in the learning process to make school exciting and enjoyable.
- work with parents as "Partners in Education."
- think safety first in all I do.

Parent's Pledge

I will

- provide a home environment that will encourage my child to learn.
- insist that all homework assignments are completed.
- discuss what is going on at school.
- contact and meet with my child's teachers.
- remind my child of the necessity of discipline in the classroom.
- help my child appreciate and enjoy the excitement of learning.
- work with the school as "Partners in Education."

WSD Continuous Nondiscrimination Notice

The Wausau School District does not discriminate against individuals on the basis of sex, race, religion, national origin, ancestry, creed, pregnancy, marital or parental status, sexual orientation, or physical, mental, emotional, or learning disability. Federal law prohibits discrimination in education and employment on the basis of age, race, color, national origin, sex, religion, or disability.

Anyone who believes that the Wausau School District has inadequately applied the principles and/or regulations of Title VI, Title VII, Title IX, Section 504 or the Americans with Disabilities Act, may file a complaint with the WSD Equity Director at the Longfellow Administration Center, 415 Seymour Street, Wausau, Wisconsin 54402-0359, or by telephone at 715-261-0500.

Lub Wausau School District txwv tsis pub leejtwg ua saib tsis taus ib tus neeg twg txawm yog hais tias nej yog pojniam los yog txivneej, yog haiv neeg dabtsi, ntseeg dabtsi, poj koob yawm txiv yog leejtwg, nyiam pojniam los yog txivneej li cas, muaj mob nkees li cas los yog xiam oob qhab li cas. Kevcai nyob rau tebchaws no txwv tsis pub leejtwg yuav ua saib tsis taus nej yog nej tuaj nrhiav haujlwm ntawm peb txawm yog nej yog haiv neeg twg, muaj noob nyoog li cas, cev nqaij daim ntawv yog xim dabtsi, nyiam pojniam txivneej, ntseeg dabtsi, los yog muaj kev xiam oob qhab li cas.

Yog leejtwg ntseeg tau hais tias lub khoog tsev kawm ntawv Wausau School District ua tsis raws li txojcai thiab/los yog cov lus teev tseg nyob rau Title VI, Title VII, Title IX, Section 504 los yog Txojcai Tiv Thaiv Haiv Neeg Mekas uas Xiam Oob Qhab, nej sau tau ib tsab ntawv tsis txaus siab tuaj rau tus saib xyuas tej teebmeem zoo li no uas yog tus WSD Equity Director nyob tom Longfellow Administration Center, 415 Seymour Street, Wausau, Wisconsin 54402-0359, los yog hu rau nws ntawm tus xovtooj 715-261-0549.

El Distrito Escolar de Wausau no discrimina contra las personas por motivos de sexo, raza, religión, nacionalidad, ancestro, credo, embarazo, estado civil, orientación sexual, o discapacidad física, emocional, mental o de aprendizaje. La Ley Federal prohíbe cualquier tipo de discriminación en la educación y empleo por motivos de edad, raza, color, nacionalidad, sexo, religión o discapacidad.

Cualquier persona que crea que el Distrito Escolar de Wausau ha aplicado inadecuadamente los principios y/o reglas del Título VI, Título VII, Título IX, Sección 504 o del Acta para Americanos con Discapacidades, podrá presentar una denuncia ante el Director de Igualdad del Distrito Escolar de Wausau al Centro de Administración Longfellow, 415 Seymour Street, Wausau, Wisconsin 54402-0359, o por teléfono al 715-261-0596.

Administration reserves the right to make changes or corrections in any school policy or rule addressed in this agenda. In addition, items not addressed in this agenda or the WSD Parent/Student Handbook are left up to the discretion of the administration.

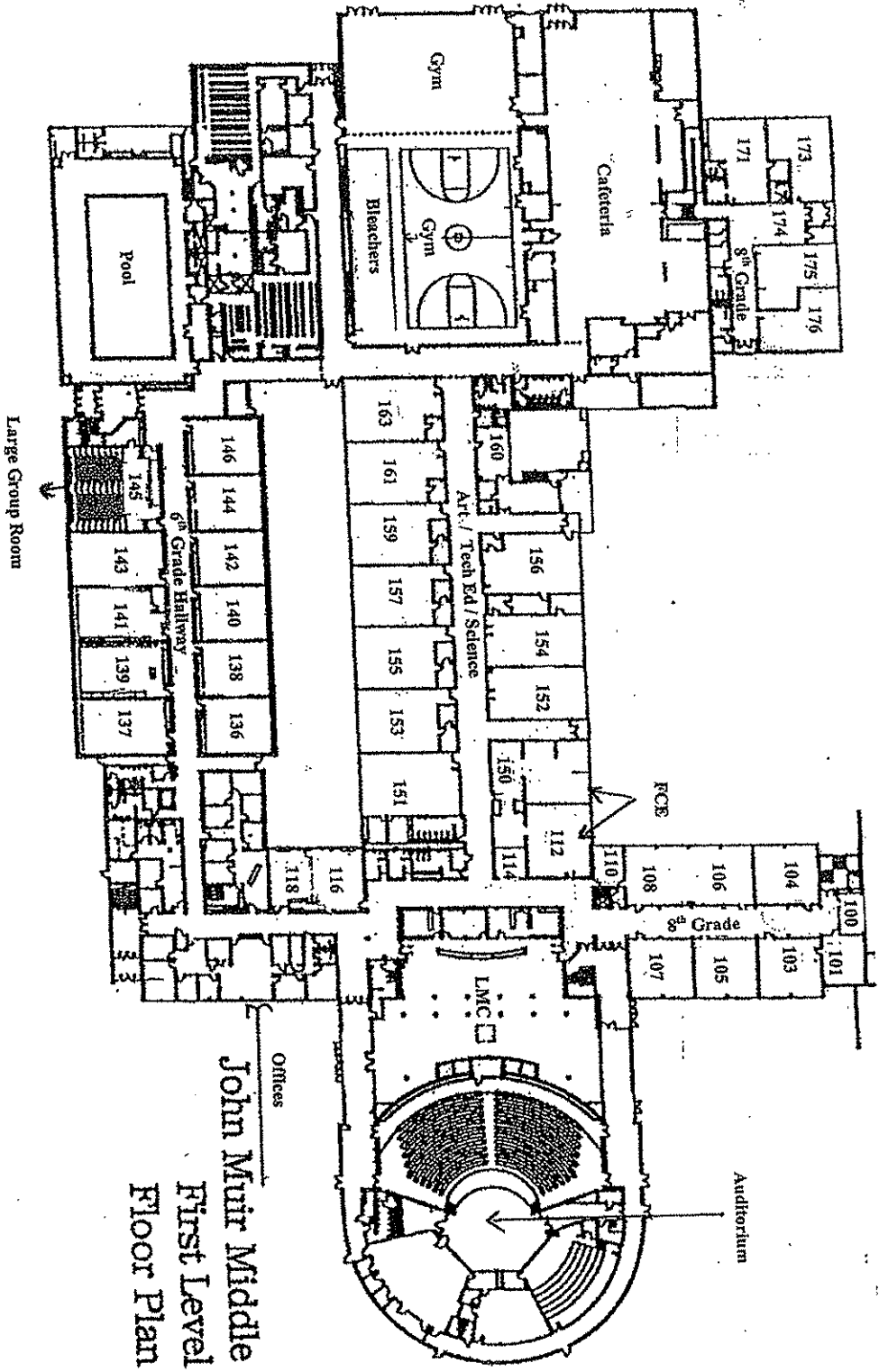

John Muir Middle School
 First Level
 Floor Plan

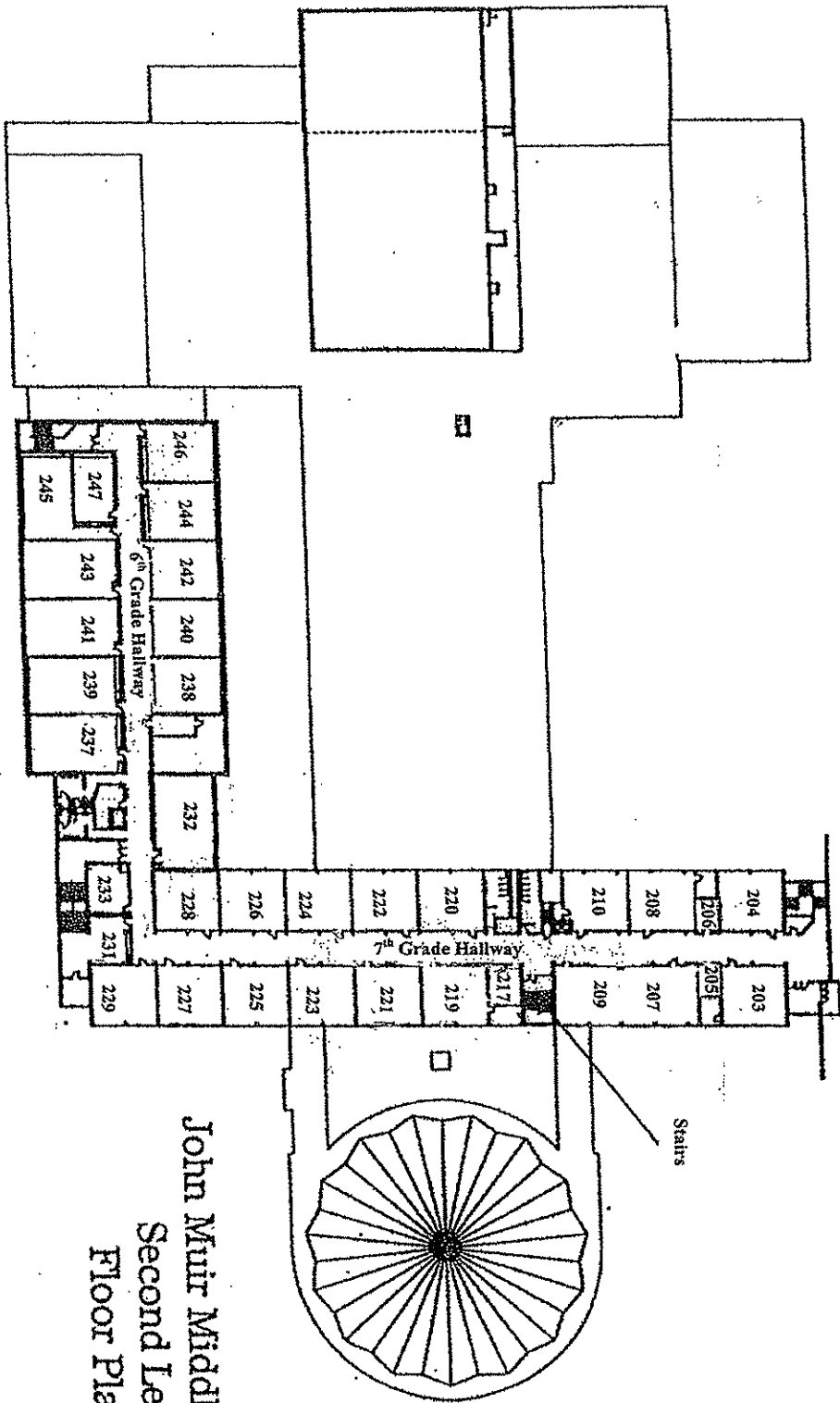

John Muir Middle School
 Second Level
 Floor Plan

**Notes
&
Important Information**

Scavenger Hunt

Name: _____

Team: _____

1. What does N.E.T. stand for?
2. Name two guidelines to follow when serving an after-school detention.
3. What form should your parents fill out if they know you will be missing school?
4. Students who violate dress and appearance rules will be dealt with in what manner?
5. What three items do you need written in your agenda when getting a hall pass?
6. On what page in your planner is the multiplication table shown?
7. After cleaning up the table and floor, what will you need to do in order to be excused from the lunch table?
8. If you are not serving detention, in an after-school activity, or under the direct supervision of a staff member, you must be out of the building at what time?
9. Who is the Principal of John Muir Middle School? Who are the Associate Principals?
10. John Muir's life can be summarized with this quote:

Scavenger Hunt

11. What time will the warning bell ring?

12. Who is the current Student Council President?

13. On what page would you find science formulas?

14. For students causing problems on the bus, the 3rd offense results in what discipline action?

15. What is the capital of New Jersey? On what page is this located?

16. Use of physical force against another student, obscene conduct, verbal harassment of an other person, vandalism of school property, and use of profane language/gestures may result in a suspension from school for up to how many days?

17. What are the hours the LMC is open?

18. What pages are the John Muir maps located?

19. Name three Dress Code violations.

20. What are the six types of harassment? Provide one example of each form.